



BIOBreeze

ultrasonic aroma humidifier with clock



OA 1512 User Manual

Safety Instructions

BEFORE USING THIS PRODUCT, READ THE INSTRUCTIONS CAREFULLY FOR CORRECT USE OF THE PRODUCT; TO PREVENT UNWANTED PERSONAL INJURY AND PROPERTY LOSS CAUSED BY MISUSE, USERS SHOULD PAY ATTENTION TO THE FOLLOWING ISSUES WHEN USING THE PRODUCT:

1. Check the household voltage to ensure that it matches the rated voltage on the specifications before operating.
2. DO NOT add water directly into the mist outlet, which may damage the device.
3. Children should be properly supervised to ensure that they do not play with the product.
4. Children should be properly supervised to ensure that they do not play with any product components or product packaging, such as plastic bags.
5. To avoid fire hazards, NEVER put the cord close to heat sources, such as radiators, stoves, and heaters.
6. Do locate your Aroma Diffuser by an inside wall near an electrical outlet. Do place the Aroma Diffuser 10cm far away from the wall.
7. Place your Aroma Diffuser far away from corrosive and furniture, etc. Do protect it from sun.
8. If the Aroma Diffuser is faulty, DO NOT operate any part of the product, such as a damaged cord or plug. If the appliance is damaged or faulty, return it to the dealer for examination, adjustment, and repair of the circuit and appliance.
9. Always place the Aroma Diffuser on a firm, flat, level surface at least 60cm above the floor.
10. DO NOT directly face the mist outlet towards the wall or any wood furniture.
11. NEVER tilt, move, or attempt to empty the unit while it is operating.
12. DO NOT add water, essential oil, or pharmaceuticals into the Aroma Diffuser or move it without first unplugging the unit from its electrical outlet.
13. DO NOT attempt to repair or adjust any electrical or mechanical functions of this unit. Doing so will void your warranty. The inside of the unit contains no user-serviceable parts. All servicing should be performed by qualified personnel only.
14. DO NOT plug in the cord with wet hands: this could result in electric shock.
15. NEVER use detergents, gasoline, kerosene, ethyl alcohol, glass cleaner, chemical detergents or other household solvents to clean any part of the Aroma Diffuser.
16. DO NOT add water, essential oil, or pharmaceuticals over the MAX LINE.
17. DO protect the base from water and avoid placing the base in water. If there is water inside the base, please dry the base by a hair dryer (DO NOT place the hair dryer too close to the base while drying). DO NOT use the device before completely drying. You can also return the device to the maintenance station for drying.
18. Be careful when adding essential oil or other corrosives. DO NOT let them splash into contact with your eyes.

Warranty Claims

1. Warranty is not transferable.
2. This warranty is effective only if the product is purchased from OGAWA.
3. Proof of purchase (original receipt) is required for all warranty repairs.
4. All implied warranties, including but not limited to these implied warranties of fitness and merchantability, are limited to the duration stated in the warranty policy.
5. Damage due to misuse, improper treatment and unauthorized modification and repair are not covered by this warranty.
6. Warranty does not cover accessories and attachments which do not belong to the massage unit.
7. Warranty is not effective to rental, business, commercial, institutional or other non-residential users.
8. All services covered by this warranty must be approved by OGAWA and repaired by authorized technicians only.
9. If replacement parts for defective materials are not available, OGAWA reserves the right to make substitution in lieu of repair or replacement.

Product Parts

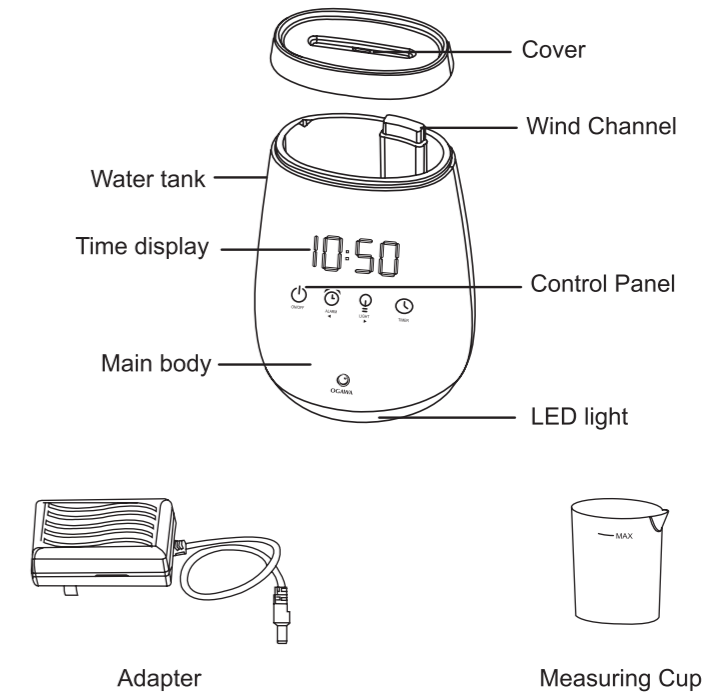

Product Operation Guide

1. Take off the outer cover.
2. Use the measuring cup to add the water into the water tank. DO NOT add the water beyond the MAX. Otherwise the diffuser may not work, or the diffusing amount may be very small.
3. Add 3-5 drops essential oil.
4. Place the top cover.
5. Connect to the power cord.
6. Settings
 - POWER : Touch the button to turn on and off the unit.
 - ALARM CLOCK Touch the button to turn on and off the function. Long press to enter setting mode (the LED time display will flicker). Touch to set the Minutes and touch to set the Hours. After you set the expected time, long press to confirm and complete alarm clock setting. When the clock reaches the Time you set, the device will alarm 60 seconds, and meanwhile it begins to work with diffuser and LED light both on. You can set the alarm when the device is powered on.
 - LIGHT : After power-on, touch the button once to turn it on, and the light will be in auto color-changing mode; touch it for a second time, and the light will turn red; touch it for a third time, and it will turn green; touch it for a fourth time, and it will turn blue; touch it for a fifth time, and it will turn OFF.
 - TIMER Touch the button to set the diffusing timer. Touch the button once, and the diffusing timer will work for 30 min; touch the button for a second time, and the timer will work for 60 min; touch the button for a third time, and the timer will work for 120 min; touch the button for a fourth time, and the timer will be OFF.
 - LED TIME DISPLAY: Long press to enter setting mode (the LED time display will flicker). Touch to set the Minutes and touch to set the Hours. After the setting, long press .

Product Operation Guide

- AFTER EACH USE**
7. Turn the device OFF and unplug the unit from the electrical outlet. Then lift up the top cover and water tank of the aroma diffuser.
 8. Drain and rinse the water tank thoroughly to remove any sediment and dirt.

SPECIAL ATTENTION BEFORE USING

- Pay more attention while filling essential oil or other corrosive materials. Avoid it coming to your eyes.
- Place the Aroma Diffuser on a flat surface, at least 60cm above the floor and 10cm away from the wall. We advise you to place the Aroma Diffuser far away from corrosives and furniture.
- Be sure the Aroma Diffuser and power cord is far away from where children can get, to avoid any danger.
- DO NOT fill water or essential oil directly from the mist outlet.
- DO NOT fill water with more than 40°C.
- DO NOT fill water from mist outlet while cleaning the base. Or, the electronic components in the base will be damaged.
- Use the measuring cup to add water into the water tank. DO NOT add the water beyond the MAX level mark of measuring cup. Diffuser will not work or the diffusing amount will be very small if the diffuser is filled beyond the MAX level mark.
- Stop operating the diffuser when the electronic components house is filled with water, Send the device to the manufacturer or dealer, but DO NOT repair it or take it apart by yourself.

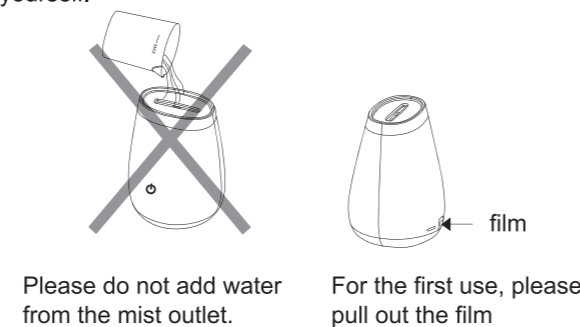

Product Maintenance

DAILY CLEANING AND WEEKLY MAINTENANCE

- Clean the water tank every week. Before cleaning, turn the power to OFF and unplug the unit from the electrical outlet.
- Add some white vinegar into the water tank for a while, then wipe off the scales in the basin especially in the transducer with a soft brush, soft cloth or paper towel. (DO clean the transducer softly to avoid damage for transducer)
- DO NOT put the whole device or the base in the water. DO NOT use water that is more than 50°C to wash the device.
- When you need to store the diffuser, please make sure that the device is clean and dry, before leaving it in a cool place without exposure to strong sunlight.

KIND NOTE

1. Using the device in a correct way and periodic maintenance can ensure proper operation and a longer lifespan of the device.
2. Send the device to repair stops or manufacturer, but do not do any repair or open the electronic components portion by yourself.

Troubleshooting

Conditions	Possible reason	Solutions
Humidifier does not operate.	1. Power cable not plugged in. 2. Power cable not plugged in properly.	1. Plug in power cable. 2. Check the power cable, and then plug it correctly.
The power light is on, but the humidifier doesn't work	1. Lack of water in the water tank. 2. The outer cover is placed incorrectly. 3. Some dirty impurities on the transducer or in the water tank. 4. Add too much water that is not so clean or add water with too much mineral substance. 5. Temperature of water is too low. 6. Circuit fault. 7. Too much water in water tank.	1. Fill water in the water tank. 2. Place the inner cover and outer cover in a correct way. 3. Please do regular maintenance. 4. Wash the water tank, then refill with clean water. 5. Pour out the water, then refill with water that is more than 20°C. 6. Send it to Repair Centre. 7. Pour out some water so that it is below the max line.
The water mist produces an unpleasant smell.	1. There is unpleasant smell in the water tank or mist channel. 2. The water tank is not cleaned regularly. 3. Dirty water or water is left inside for too long.	1. Clean the water tank and mist channel. 2. Please do regular maintenance. 3. Clean the water tank and mist channel, then refill with clean water.
Water leakage or mist leakage.	1. Blockage in water tank. 2. The outer cover is placed incorrectly.	1. Clean the water tank thoroughly. 2. Replace the outer cover in the correct way.

Product Specifications

Product Name	BioBreeze Ultrasonic Aroma Humidifier with Clock.
Model number of the product	OA 1512
Rated Voltage	DC 24V
Rated Power	12W
Water Capacity	0.1L
Moisture Capacity	15ml/h
Dimensions	116 x 112 x 162 mm
Weight	0.4 kg
Coverage Area	15 m ²

Contact Us

<p>MALAYSIA Healthy World Lifestyle Sdn Bhd No. 22 Jalan Anggerik Mokara 31/47 Kota Kemuning, 40460 Shah Alam Selangor Darul Ehsan, Malaysia Tel : +603-5121 4286 Fax: +603-5121 4386</p>	<p>HONG KONG, CHINA OGAWA Health Care International (HK) Ltd Room 715&718 7th floor International Trade Centre 11-19 Sha Tsui Road Tsuen Wan New Territory Hong Kong Tel : +852 3465 6262 Fax: +852 2410 0119</p>
<p>SINGAPORE OGAWA Health-Care Pte Ltd 17 Kaki Bukit Road 2 K. B. Warehouse Complex Singapore 417846 Tel : +065-6846 8588 Fax: +065-6846 7677</p>	<p>VIETNAM OGAWA Vietnam 171 Nguyen Thi Thap Street Tan Phu Ward Dist 7 Ho Chi Minh City, Vietnam Tel : +84 8 3775 3093 / 3775 3094 Fax: +84 8 3775 3095</p>
<p>INDONESIA PT Healthy World Lodan Center Block O No 20 Jalan Lodan Raya No 2 Jakarta Utara 14430 Tel : +62 21-6983 1123 Fax: +62 21-6983 1124</p>	<p>PHILIPPINES O-Healthcare Solution Phil.Inc. 2303, 4th Floor, G&A Building, Chino Roces Avenue Extension, Makati City, Philippines Tel : +632 889 0676 / +632 844 6851 Fax: +632 812 0421</p>